



- IT** Tiralatte elettrico indossabile
- ES** Sacaleches eléctrico portátil
- EN** Electric wearable breast pump
- FR** Tire-lait électrique portable
- DE** Elektrische tragbare Milchpumpe
- PT** Bomba tira leite elétrica vestível
- GR** Ηλεκτρικό φορετό θήλαστρο
- NO** Elektrisk bærbart brystpumpe

MATERNO SMART WEAR



1287W
1287KDW
1288W

- IT** Manuale istruzioni d'uso
- ES** Manual de instrucciones de uso
- EN** Instruction manual
- FR** Manuel d'instructions d'utilisation
- DE** Bedienungsanleitung
- PT** Manual de instruções de uso
- GR** Εγχειρίδιο οδηγιών χρήσης
- NO** Bruksanvisning

Dear Customer, you bought one of the most reliable breast pumps actually available in the market. We studied this device to be as much user friendly as possible but, we are afraid, you still have to spend a small amount of time in reading these instructions in order to get 100% of the benefits this product can bring you. Keep this manual for future reference. Be sure to bring four AA alkaline batteries for travel use.

ATTENTION

- Please do not leave this product in a high temperature environment for a long time.
- Please clean this product before and after use.
- Before breast pumping, please check again whether the related accessories are correctly assembled and closely matched.
- When assembling or disassembling, please be sure to assemble or disassemble each part according to the 'Assembly Method'.
- The materials used in this product meet the national safety standards, and it is normal to have residual odour.
- If you want to use the electric breast pump in the stage of less lactation, please use it under the guidance of doctors and nursing staff.
- Please don't over breast feed to avoid breast injury.
- If you feel pain caused by using this product, please stop using it immediately and ask the medical staff.
- Breast pump parts that come into direct contact with breast milk are personal care products, and mothers should not share them.
- This product is only for the purposes described in this manual.

WARNING

- Do not use it in the bath or shower.
- Be careful not to twist or knot the connecting tube.
- When not in use, please keep it out of the reach of children.

PACKAGING CONTENT

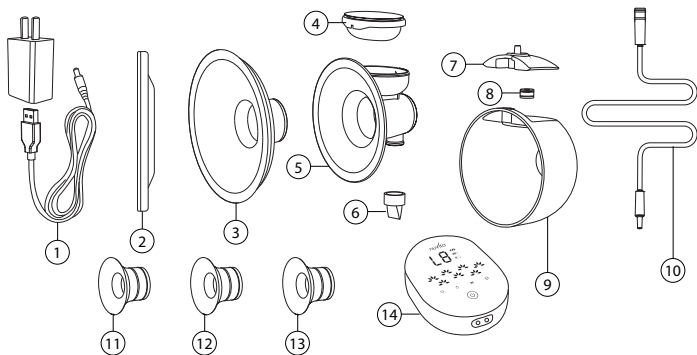

	Item	1287W Quantity	1287KDW Quantity	1288W Quantity
1	Power adapter	1	-	1
2	Dust-proof cover	1	1	2
3	Breast cup	1	1	2
4	Suction cup	1	1	2
5	Breast pump body	1	1	2
6	Suction valve	1	1	2
7	Cap	1	1	2
8	Sealing ring for cap	1	1	2
9	Milk container	1	1	2
10	Connection tube	1	1	2
11	20 mm silicone reducer	1	1	2
12	22 mm silicone reducer	1	1	2
13	24 mm silicone reducer	1	1	2
14	Breast pump control unit	1	-	1
15	Velvet bag (not shown in the diagram)	1	-	1

ASSEMBLY METHOD

1. Insert the breast cup "A" to the breast pump body "D".
2. Put the suction bowl "C" on the top of the breast pump body. Ensure the edge of the suction silicone bowl is closely matched and the position limiting notch is installed in place.
3. Fix the suction valve "E" to the bottom of the breast pump body and ensure the suction valve is fully pushed in. The suction valve cannot be installed horizontally, and it must be installed as shown in the figure.
4. Fix the breast pump body assembly to the milk container "H" and make sure they are closely matched.
5. Push the cap assembly onto the milk container and make it fit together.
6. For extraction from a single breast, please connect the main breast pump unit and milk container assembly with a connection tube.
7. For double expression (double breast pump mode), please connect the main breast pump unit and 2 milk containers assemblies with 2 connection tubes.

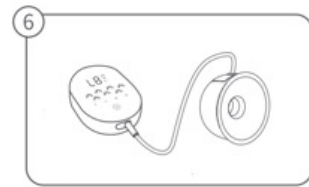
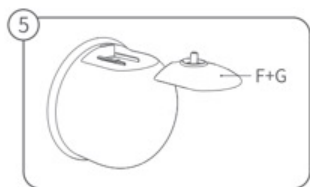
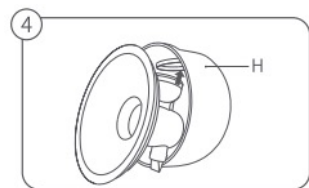
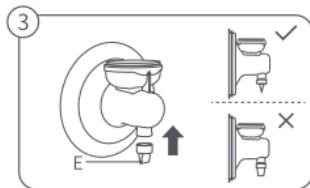
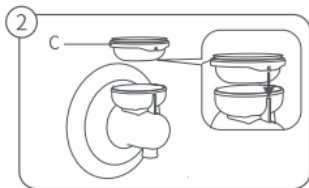
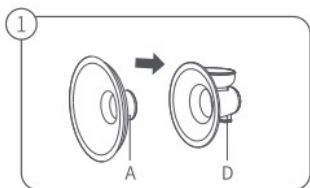

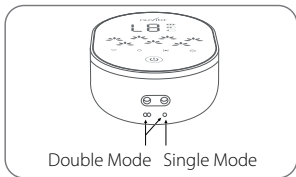
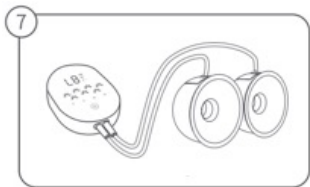

PRODUCT FEATURES

1. This Breast pump uses a **3 Phases Technology: 1st Phase** with 9 selectable stimulation levels for 2 minutes operation. **2nd Phase** with 9 Selectable levels for your best Expression action. **3rd Phase** (selectable on demand) to completely empty the breast and prevent galactostasis (engorgement)
2. This device is provided with an anti-reflux protection system which prevents the breast milk to return to the control unit and damaging it during the milk extraction process.
3. It is portable (AC/DC and Rechargeable Battery operated) so suitable for travelling and perfect for breast pumping activity at work.

PUMP CONTROL UNIT

- A1. On and Off Switch button
 A2. Stimulation Mode button
 A3. Expression Mode button
 A4. Drainage / Anti-stasis Mode button
 A5. Single / Double Mode button (Light ON - SINGLE pump / Light OFF - DOUBLE pump)
 B1. Level indicator
 B2. Battery indicator
 B3. Rhythm indicator

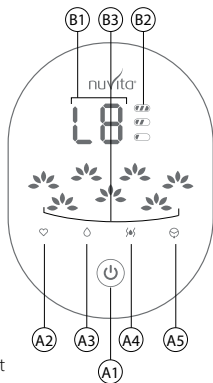

Intensity levels:

- | | | |
|---|--------------------|---|
| ♥ | from 1 to 9 | This is the Stimulation mode with fast and short suction rhythm. |
| 💧 | from 1 to 9 | This is the Expression mode. This simulates the suction of a baby. The rhythm of this phase is slower, deeper and longer. |
| 🔥 | from 1 to 9 | This is the Drainage / Anti-stasis mode. This helps preventing Galactostasis. |

OPERATING INSTRUCTIONS

1. Wash your hands before use, confirm that the breast pump assembly is thoroughly cleaned and properly installed in place according to the assembly instructions.
2. Align the centre of the assembled milk container with the nipple and keep it close to the breast, and hold the breast with the other hand to ensure that no air enters.
3. Adjust the nursing bra to a proper tightness, fix the milk container in place, keep body upright, and start breast pumping after the breast pump is correctly connected to the main unit. (Note: Do not lie down, bend, tilt or move violently when pumping).
4. If the nipple diameter does not match the breast cup diameter, a silicone reducer can be used; Insert the silicone reducer into the breast cup and ensure a tight fit.
5. After the breast pumping is completed, remove breast pump body assembly, push out the cap from the milk container for disassembly, and pour the milk into the milk storage bottle or milk storage bag. (Note: Do not exceed the maximum scale of 180ml).
6. After disassembly and cleaning, the connector body, breast cup, milk container, suction bowl and suction valve and other accessories can be put into the steriliser for disinfection. (Note: The tube assembly and the cap assembly cannot be sterilised). Clean and sterilize the non electronic parts for next use.

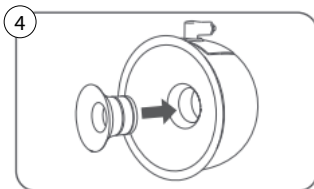
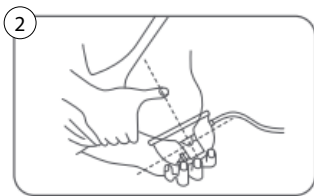
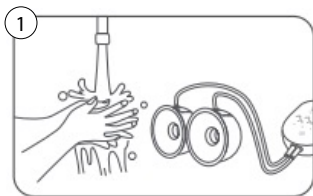

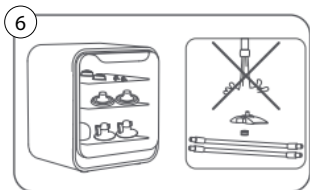
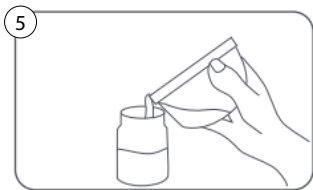



OPERATING PUMP CONTROL UNIT

- Power on, press "A1" power button. The screen of the machine will self-test and flicker.
- Press "A2" will enter stimulation mode. The factory default level is level. Press "A2" again to increase the level of suction intensity. After 2 mins of stimulation, the machine will auto switch to Expression mode. Press "A3" again to increase the level of suction intensity. Machine will auto shut off after 30 mins working. Press "A3" to enter Expression mode if your milk starts to flow earlier. Press "A3" again to increase the level of suction intensity. Machine will auto shut off after 30 mins working.
- In Expression Mode, Press "A2" again to enter stimulation mode again at the same level of suction intensity in previous Stimulation session. After 2 mins of stimulation, the machine will auto switch to expression mode. Machine will auto shut off after 30 mins working.
- Press "A4" to enter Drainage mode when you prefer. Press "A4" again to increase the level of suction intensity. Machine will auto shut off after 5 mins.

INSTALLATION OF AC ADAPTOR

IMPORTANT: Please turn off the machine before connecting with the adaptor.

1. Insert DC round pin of AC power adapter into the DC socket at the Control Unit, and insert the AC power adapter into the power socket as shown in the diagram.
2. When battery is low capacity, only the icon  will flicker, indicating that the machine needs to be charged.
3. When charging, the 3 battery icons on the screen will flicker.
4. When machine full charged, the icon  will be always on.

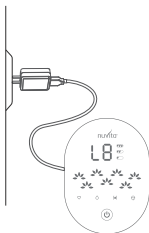

CLEANING INSTRUCTIONS

- After each use, please clean the cleanable accessories in time.
- Do not use steel wire, sharp instruments or corrosive chemicals to clean this product.
- It is recommended to use soft sponge brush and neutral detergent to clean this product.
- When disassembling and cleaning, the accessories such as connector body, breast shield, milk collector, suction bowl and valve can be put into the sterilizer for disinfection. (Except the tube assembly and the cap assembly)
- Suction bowl and valve are made of silicone, which are consumable. It is not advisable to sterilize them at high temperature for a long time, so as not to cause excessive aging or deformation and affect their use.
- Do not immerse the connecting tube assembly and cap assembly in water for cleaning, and only wipe them with a clean wet cloth. (The wetted cap assembly and connecting tube assembly will cause permanent damage to the main machine of the product.)
- When disassembling and cleaning, please be careful about the smaller parts to avoid losing them, which may lead to the failure of assembly or machine operation.
- When cleaning, please gently wash the valve, suction bowl and other parts. If they are damaged, the suction will be affected and the breast pumping cannot be working normally.
- This product cannot be heated and disinfected in microwave oven.

HOW TO CHOOSE THE RIGHT REDUCER

The milk extraction should be a pleasant action and the size of the breast cup greatly affects the type of experience that is lived while using the breast pump. The Nuvita reducers are available in 3 sizes: 20, 22 or 24 mm.

1. With a ruler or a measuring tape, measure the diameter of the nipple (in mm), passing through the centre and excluding the areola.
2. Based on the mm measured, choose the breast reducer that is the closest to the measured value.

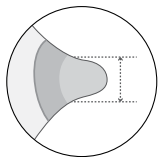

**Size of
nipple**

UPTO
16 mm

UPTO
18 mm

UPTO
20 mm

**Size of
reducer**

∅ **20**
mm

∅ **22**
mm

∅ **24**
mm

WARRANTY - TERMS AND CONDITIONS

This product benefits of a warranty of 24 months on material and manufacturing defects, starting from the date of purchase (see sales slip). The warranty of 24 months does not include damages caused by the usual use of parties identified as "consumable" (e.g., batteries, brush heads or parts subject to usury). The legal guarantee of 24 months is void if: **1.** The product has undergone aesthetic damage due to improper use not in accordance with instructions in the manual. **2.** This product has been modified and/or tampered with. **3.** The cause of the failure was due to poor maintenance of the individual components and/or accessories and/or supplies (e.g. oxidation and/or scaling due to the retention of water or other liquids, sediment blocking the sensor, leak of corrosive liquid from batteries). The following is excluded from the legal guarantee of 24 months: **1.** Costs related to replacements and/or repair of parts subject to wear or costs for ordinary maintenance of the product. **2.** The costs and risks involved in transporting the product to and from the store where you purchased or otherwise authorized collection centre to receive the products under warranty. **3.** Damage caused by or resulting from improper installation or improper use not in accordance with the directions in the instruction manual. **4.** Damage due to natural disasters, accidental events or adverse conditions not compatible with the product. **5.** Defects that have a negligible effect on product performance. The manufacturer, distributor and all the parties involved in the sale do not assume any liability for losses and economic damage from any malfunction of the product. In accordance with current regulations the manufacturer, distributor and all the parties involved in the sale are not responding in any case for damages, including direct, indirect ones, loss of net income, loss of savings and additional damage and other details consequences going beyond the damage caused by the breach of warranty, contract, strict liability, wrongdoing or due to other causes, resulting from the use or inability to use the product and/or paper and electronic documents, including the lack of service. For further information on the help service visit the website www.nuvitababy.com



www.nuvitababy.com
info@nuvitababy.com

IMPORTED / DISTRIBUTED BY

Anteprima Brands International Ltd
1, Ferris Bldg. St.Luke Street PTA1020 Gwardamangia
Malta - Europe

All rights reserved
1287W_23_Gen_v1.0.0
1287KDW_23_Gen_v1.0.0
1288W_23_Gen_v1.0.0

