



- IT** Umidificatore a vapore freddo
ES Humidificador a vapor frío
EN Cool steam humidifier
FR Humidificateur à vapeur
DE Dampfsterilisator Für Babyflaschen
PT Humidificador a vapor frio
GR Υγραντήρας δροσερού ατμού
CZ Zvlhčovač vzduchu na studenou
HU Hideggőzös párasító
SK Studený parný zvlhčovač
LT Šaltų garų drėkintuvas

Ariasana 3



EN Ariasana 3

Silver Ion Ultrasonic Cool Steam Humidifier

IMPORTANT SAFEGUARDS

When using electrical appliances, basic precautions should always be followed to reduce the risk of fire, electric shock, and injury to persons, including the following:

- Use this humidifier only as described in this manual. Other use not recommended may cause fire, electric shock or injury to persons.
- Always have water in the water tank when operating the unit.
- Use only clean, cool tap water to fill the tank. If you have hard tap water, it is strongly suggested to use distilled water.
- Be sure the cap of the water tank is firmly tightened.
- When adding water to the tank, make sure water does not enter the mist output opening.
- During operation, rotate the mist nozzle so it aims away from children, walls and furniture.
- This product is intended for household use ONLY and not for commercial, industrial or outdoor use.
- Do not add medication of any type into the nozzle, base or water tank.
- Do not cover any openings on the unit or insert objects into any openings.
- Do not tilt or tip the unit or attempt to empty or fill while in operation.
- Do not leave the unit unattended in closed rooms as the air could become saturated and leave condensation on walls or furniture. Always leave the room door/window partly open.
- To protect against electric shock, do not immerse unit, plug or cord in water or other liquids.
- This appliance has a polarized plug (one blade is wider than the other). To reduce the risk of shock, this plug is intended to fit only one way in a polarized outlet. If the plug does not fit fully in the outlet, reverse the plug. If it still does not fit, contact a qualified electrician. DO NOT attempt to defeat this safety feature.
- Keep the cord away from heated surfaces and areas where it could be walked on or tripped over.
- Use only a 110-120V AC outlet
- Close supervision is necessary when any appliance is used by or near children.
- Turn the unit OFF and unplug from the outlet when not in use, when moving from one location to another and before cleaning.
- To disconnect, first turn the unit OFF, grip the plug and pull from the wall outlet. Never pull the plug by the cord.
- Do not operate the humidifier in the presence of explosive and/or flammable fumes.
- Do not place the humidifier or any parts near an open flame, cooking or other heating appliance.
- Do not operate humidifier with a damaged cord or plug, or if the product malfunctions, or dropped and damaged in any manner (see warranty).
- The use of attachments not recommended by the manufacturer may be hazardous.
- Place the humidifier on a flat, level surface away from direct sunlight.
- Do not operate if the housing is damaged.
- A loose fit between the AC outlet (receptacle) and plug may cause overheating and a distortion of the plug. Contact a qualified electrician to replace loose or worn outlet.

To prolong the life of this humidifier, using distilled water is highly recommended. Do not add fragrance or oil in the water, it will cause the machine to malfunction and void the warranty.

NOTE ON HUMIDITY LEVELS

- It is best to keep the humidity level between 30~50 percent of relative humidity.
- The comfort level of humidity will vary from room to room and with changing room conditions.
- In cold weather, windows and sometimes walls may fog or develop frost from excessive indoor humidity. If this occurs, reduce the mist intensity setting to avoid damage from condensed water dripping on windowsills.
- Too much humidity in the room may allow moisture to accumulate on surfaces where bacteria and fungi can grow. Moisture that gathers may also damage furniture, walls and wallpaper.
- To eliminate excessive humidity, especially in smaller rooms, leave the room door or window open and adjust the mist intensity control accordingly.

PARTS IDENTIFICATION

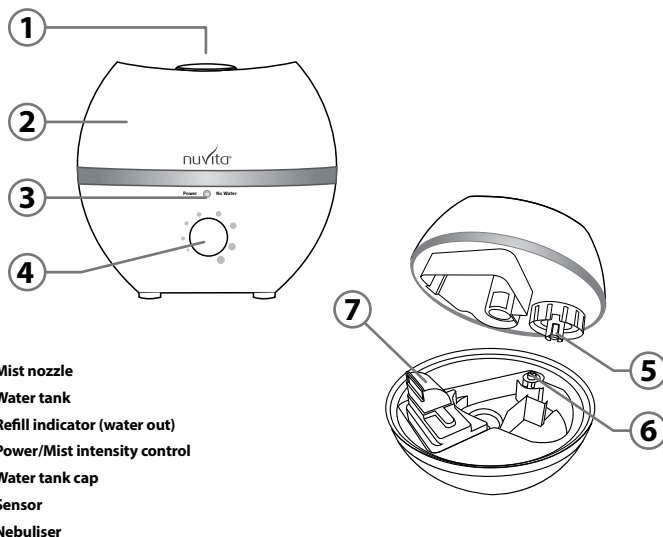

OPERATING INSTRUCTIONS

- Lift and remove mist nozzle.
- Remove water tank by grasping firmly and lift up.
- Turn water tank over and turn the cap counter-clockwise to open. Fill with COOL tap water or DISTILLED water. DO NOT USE HOT WATER. Do not add fragrance or oil in the water – it will cause malfunction of the unit!
- Replace the fill cap by turning clockwise – do not over tighten.

NOTE: When carrying a filled water tank, place one hand under for support.

- Place water tank back in place, making sure the tank is correctly aligned with the body; then replace the mist nozzle.
- Plug in power source.
- Turn the Power/Mist Intensity knob clockwise to turn on. You will hear a “click”.
- To adjust mist intensity, turn the Power/Mist Intensity knob accordingly. Clockwise increases mist intensity and counter-clockwise decreases.

NOTE:
Once the water tank is in place, do not attempt to move the humidifier. If it has to be moved, unplug the unit and drain water from the base before moving.

Once the unit is plugged in or during operation, do not attempt to pick up the water tank.

Pay attention to the water level - add water when low.

CARE AND MAINTENANCE

- Turn off power and unplug unit before cleaning.
- Never use a detergent or any cleaning chemicals to clean the tank or base. Detergent dissolved in the water supply can interfere with the mist output.
- If water tank is extremely dirty, soak with mild bleach and water solution and rinse clean. Never use detergent.
- Wipe the exterior of the body with a damp cloth.
- Do not spray water or any liquid onto the control.
- Never immerse the base in water or let water enter the air outlet or other openings.
- Clean and rinse the water tank and mist nozzle with lukewarm water frequently to avoid mineral build up.
- Keep the nebulizer and water sensor free of mineral deposits. Remove water tank and empty the reservoir. Clean the nebulizer and sensor with a soft brush (old toothbrush). Do not scrape the nebulizer or water sensor. Do not clean with tools that have metal parts.
- Leaving water to sit in the tank for more than a couple days may cause bacterial growth. Always empty the tank if not planning to use for a few days even though the ceramic filter destroys any bacterial growth in the tank.

STORAGE

- Save the box for off-season storage.
- Clean the tank, base and all parts thoroughly and dry completely before storage.
- If water is left in the unit during storage, it may harden and leave deposits that may affect the unit from operating properly.
- Leave the cap of the water tank loose. This will prevent the cap and gasket from sticking together and prolong the life of the gasket.
- Rinse the silver ion stick under clear running water and store back in place
- The ceramic filter normally lasts for 2 years, store it in a cool dry place.

TROUBLESHOOTING

Unit is not producing mist.

- Check if unit is powered on.
- Turn the mist intensity level higher (clockwise)
- Check if water is in the tank.
- If there is water in the tank, the water level in the base may be too full. Unplug the unit, remove tank and empty the water in the base.
- Check if water tank is properly aligned in place.

TECHNICAL SPECIFICATIONS

Model	SU-2550
Input voltage	AC 120V ~60Hz
Power consumption	0.43A/30W
Water tank capacity	2.5L

WARRANTY TERMS AND CONDITIONS

This product benefits of a warranty of 24 months on material and manufacturing defects, starting from the date of purchase (see sales slip).

The warranty of 24 months does not include damages caused by the usual use of parties identified as “consumable” (e.g. batteries, brush heads or parts subject to usury).

The legal guarantee of 24 months is void if:

- The product has undergone aesthetic damage due to improper use not in accordance with instructions in the manual.
- This product has been modified and / or tampered with.
- The cause of the failure was due to poor maintenance of the individual components and / or accessories and / or supplies (e.g. oxidation and / or scaling due to the retention of water or other liquids, sediment blocking the sensor, leak of corrosive liquid from batteries.)

The following is excluded from the legal guarantee of 24 months:

- Costs related to replacements and / or repair of parts subject to wear or costs for ordinary maintenance of the product.
- The costs and risks involved in transporting the product to and from the store where you purchased or otherwise authorized collection centre to receive the products under warranty.
- Damage caused by or resulting from improper installation or improper use not in accordance with the directions in the instruction manual.
- Damage due to natural disasters, accidental events or adverse conditions not compatible with the product.
- Defects that have a negligible effect on product performance.

The manufacturer, distributor and all the parties involved in the sale do not assume any liability for losses and economic damage from any malfunction of the product. In accordance with current regulations the manufacturer, distributor and all the parties involved in the sale are not responding in any case for damages, including direct, indirect ones, loss of net income, loss of savings and additional damage and other details consequences going beyond the damage caused by the breach of warranty, contract, strict liability, wrongdoing or due to other causes, resulting from the use or inability to use the product and/ or paper and electronic documents, including the lack of service.

For further information on the help service visit the website www.nuvitababy.com



www.nuvitababy.com
info@nuvitababy.com

IMPORTED / DISTRIBUTED BY

Anteprima Brands International Ltd
1, Ferris Bldg. St.Luke Street PTA1020 Gwardamangia
Malta - Europe

All rights reserved
1824_21_Gen_v1.0.0

