



- EN Digital Audio Baby Monitor
- IT Audio Baby Monitor Digitale
- ES Vigila Bebés Audio Digital
- FR Moniteur Audio Digitale pour Bébé
- DE Digitales Babyphone
- PT Intercomunicador Digital para Bebê
- GR Digital Audio Baby Monitor

om+

Quadryo1



3010

- EN Instruction Manual
- IT Manuale Istruzioni d'Uso
- ES Manual de Instrucciones
- FR Manuel d'Utilisation

- DE Bedienungsanleitung
- PT Manual de Instruções
- GR Εγχειρίδιο Οδηγιών

PACKAGE CONTENT

Before installing and using the product please check if the below items:

1. Parent unit (receiver).
2. Baby unit (transmitter).
3. USB Power Cables (2 pcs.)
4. Instruction manual

If one or more items are missing or damaged please refer to your local dealer and request the replacement.

DESCRIPTION

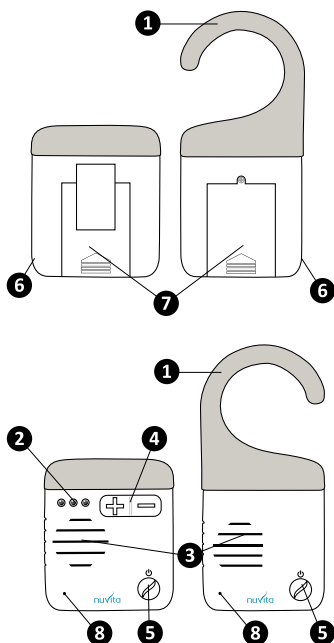

1. Antenna
2. Volume LEDs
3. Speaker
4. Volume Control
5. On/Off Switch
6. USB DC Jack
7. Battery Compartment
8. Microphone

SAFETY PRECAUTIONS



To reduce the risk of electric shock, do not remove the protection or open the power adapter. Do not wet the power adapters and the units, do not expose them to moisture and not try to open them. This could be a source of danger in addition to void the warranty.

If you use small appliances or electronic devices, especially if children are present, it is important to follow the safety precautions listed below carefully:

- This appliance is not intended for use by persons (including children) with restricted physical, sensory (e.g. insensitivity to pain) or mental abilities or persons lacking in the required experience or knowledge for safe operation of the appliance, unless supervised or instructed by a person responsible for their safety.
- The packaging components as plastic bags, boxes, foaming etc. should be kept out of reach of children as potential sources of danger.
- The Baby Monitor is not intended to replace the supervision of children by adults as it is meant to be used only as support for their supervision. Any other use is considered improper.
- Keep the product and the accessories (power adapters and cables) out of reach of children because they may constitute a risk of strangulation.
- The maximum operating distance is about 250 meters in open spaces without obstacles (the distance may be reduced significantly inside houses according to particular situations environmental, arrangement of walls and furniture in the home and the presence of metallic structures, interference/fields electromagnetic source external and internal walls of concrete reinforced or between rooms located on different floors or due to battery not fully charged, etc.).
- To avoid the risk of overheating, keep the product and power adapters away from heat sources such as radiators, thermostats, heaters, stoves, windows exposed to sunlight, etc.
- Do not use this product near fluorescent lamps (Neon) or other electrical appliances such as televisions, personal computers, WiFi Router etc.. They can cause interferences with the baby monitor.
- The replacement of batteries should always be carried out only by an adult and with batteries with the same specifications as those mentioned in this instruction manual.

PAIRING

The units are well paired by the factory but if the parent unit (receiver) loses the signal from the baby unit (transmitter), then the pairing process must be repeated as follows:

1. Connect both units to the power supply.
2. Press the pairing button in the battery compartment of both baby and parent units simultaneously using a pin and holding (refer to image).
3. Turn on both units.
4. Release both the pairing buttons after one second.

The pairing is successful only when the volume LEDs flash.

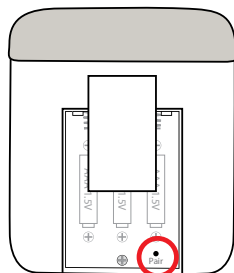

INSTALLATION AND USE

To use the Baby Monitor follow these steps:

1. Connect both the parent and the baby unit to your 5V DC ~ 1000mA power adapters (not included) through the provided USB Power Cables or insert batteries in battery compartment.

2. Switch the ON/OFF button to ON. The power LED should light up.

3. Wait for 2 seconds.

4. The parent unit and the baby unit will pair automatically. Once the pairing is
- successful the volume LED indicators will flash.

5. Put the baby unit in the baby's room at a maximum of 2m from the baby. Parents can hear the baby through the parent unit in another room.

6. Adjust the volume form the parent's unit by turning the volume control dial.

7. Refer to the LEDs as an indication of the volume level.



In case on interferences or poor signal change the channel by pressing the pairing button in the baby unit battery compartment. The baby and parent unit will search an interference-free channel to continue the operation.

TROUBLESHOOTING

If you find some problem, this chapter provides some solutions:

PROBLEM	SOLUTION
The voice quality is not clear when operating the baby monitor with batteries	Check batteries' power level and, if necessary, replace them.
No response from the receiver	When the baby unit does not detect any sound it automatically switches to standby mode (VOX function). When noise is detected it will reactivate the transmission.
Poor signal	Please make sure that the baby unit is in the operating area. You can try to change the channel or repeat pairing.

SPECIFICATIONS

Model number	3010
Operational range	Up to 250 meters
Radio technology	Digital
Frequency	2.4GHz – 2.8GHz
Operating temperature	0°C – 50°C
Storage temperature	25°C
Operating humidity	20% - 80% RH
Power transmission	17dBm
Modulation mode	FHSS
Voice covering area	Child Unit (transmitter) < / = 60m ²
Audio output	Parent Unit (receiver) 300mW
Receiving sensitivity	Parent Unit (receiver) -88dBm
Power supply	Parent Unit and Child Unit 5VDC – 1000 mA
Power consumption	Parent Unit Child Unit Min: 50mA Min: 25mA Max: 240mA Max: 125mA

WARRANTY - TERMS AND CONDITIONS

This product benefits of a warranty of 24 months on material and manufacturing defects, starting from the date of purchase (see sales slip).

The warranty of 24 months does not include damages caused by the usual use of parties identified as "consumable" (e.g., batteries, brush heads or parts subject to usury).

The legal guarantee of 24 months is void if:

1. The product has undergone aesthetic damage due to improper use not in accordance with instructions in the manual.
2. This product has been modified and/or tampered with.
3. The cause of the failure was due to poor maintenance of the individual components and/ or accessories and/ or supplies (e.g. oxidation and/ or scaling due to the retention of water or other liquids, sediment blocking the sensor, leak of corrosive liquid from batteries).

The following is excluded from the legal guarantee of 24 months:

1. Costs related to replacements and/ or repair of parts subject to wear or costs for ordinary maintenance of the product.
2. The costs and risks involved in transporting the product to and from the store where you purchased or otherwise authorized collection centre to receive the products under warranty.
3. Damage caused by or resulting from improper installation or improper use not in accordance with the directions in the instruction manual.
4. Damage due to natural disasters, accidental events or adverse conditions not compatible with the product.
5. Defects that have a negligible effect on product performance.

The manufacturer, distributor and all the parties involved in the sale do not assume any liability for losses and economic damage from any malfunction of the product. In accordance with current regulations the manufacturer, distributor and all the parties involved in the sale are not responding in any case for damages, including direct, indirect ones, loss of net income, loss of savings and additional damage and other details consequences going beyond the damage caused by the breach of warranty, contract, strict liability, wrongdoing or due to other causes, resulting from the use or inability to use the product and/ or paper and electronic documents, including the lack of service.

For further information on the help service visit the website www.nuvitababy.com

The symbol on this product means that it is an electronic product and following the European directive 2002/96/CE the electronic products have to be dispose on your local recycling centre for safe treatment.

This appliance meets the essential requirements and other relevant conditions of the applicable European Directives. The appliance complies the R&TTE European Directive 1999/5/EC requirements concerning radio equipment and telecommunications terminal equipment.



www.nuvitababy.com

Imported & distributed by:

Anteprima Brands International Ltd.,
1, Ferris Bldg, St Luke Street,
Gwardamangia, PTA1020,
Malta - Europe